

uni-cart



THE RIGHT CHOICE WHERE SPACE IS AT A PREMIUM

uni-cart masters the challenge of restricted space and difficult conditions. Optimum integration of small medical instruments enables the single-column cart to deliver the solution for flexible applications and fast mobile deployment.

uni-cart offers lots of convenience with cabling routed in the support column. The stabilizers with individual adaptation of length and angle offer a high level of stability.

This compact miracle in space can be used in a wide range of medical settings, e.g. in

- Physiotherapy
- Endoscopy
- Ultrasound diagnostics
- Anaesthesia





Ergometric application



Electrotherapeutic application



Application for hospital resuscitation



Arthroscopy application

Technical data

16

Ordering data **uni-cart**

18

THE IDEAL PLATFORM FOR YOUR SOLUTIONS



The support column permits concealed cable routing, including **socket strip**.



The **patented base design** from **uni-cart** facilitates space-saving adaptation of the platform work area in the 4-stabilizer and...



... in the 5-stabilizer variants to match the size of the instruments.



uni-cart is also supplied with **power or mechanical height adjustment** (by 300 mm).



The **swivel and tilt monitor holder** is ideal for monitors with VESA 75/100 adaptor.



The **isolating transformer** is integrated between the stabilizers to save space and is covered by an additional shelf.

uni-cart impresses in every detail

Perfect functionality

- The angle (6° increments) and length of the stabilizers can be matched to individual specifications to offer a high level of stability and flexibility.
 - ➔ The 4-stabilizer version delivers a secure solution for mounting all projecting system elements.
 - ➔ The 5-stabilizer version is ideal for centrally positioned payloads.
- The support column permits
 - ➔ mounting of e.g. infusion rod, or monitor holder,
 - ➔ the mounting option of system components on outer T-slots.
- Despite limited space, **uni-cart** provides an adequate platform and high tilt stability for payloads up to 50 kg / 110 lbs.

Safe power supply

- Socket strips can be easily integrated in the column.
- The support column offers
 - ➔ neat and concealed cable routing and
 - ➔ a strain relief integrated in the hub to protect outgoing cabling.

Consistent ergonomic design

- Integration of an optional mechanical or power height adjuster offers the desired work position (sit/stand workstation) at the touch of a button.
- Handles mounted at the front or rear and large castors (Ø 75 mm or 100 mm) guarantee optimum mobile characteristics.



THE MODULAR SYSTEM FOR INDIVIDUAL SOLUTIONS

The modular structure is the defining feature of the entire ITD product range. It allows all support systems to be configured, upgraded or modified for specialist functions and application areas. This capability allows users to react fast and consistently to any changes or new customer requirements.

The display presented alongside shows a small selection of system components and accessories for the **uni-cart** equipment carts. The entire accessories range with extensive descriptions and ordering information is presented in a user-friendly format from page 94.



1
Endoscope holder or infusion stand can be mounted in the support column or on the shelf.



2
A single handle can be fixed to the support column.

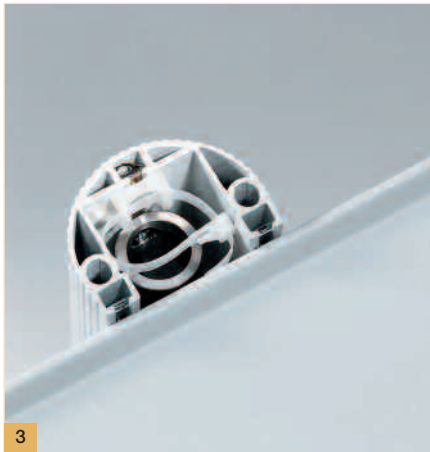

3

The **support column** is divided into a cable duct and T-slots for mounting, e.g. shelves.



4

The **shelf** is available in different versions, e.g. with handle.



5

Cabling to equipment is routed in the support column.



5

4

For an overview of system components and accessories, see page

24

DESIGN ELEMENTS AND DIMENSIONS

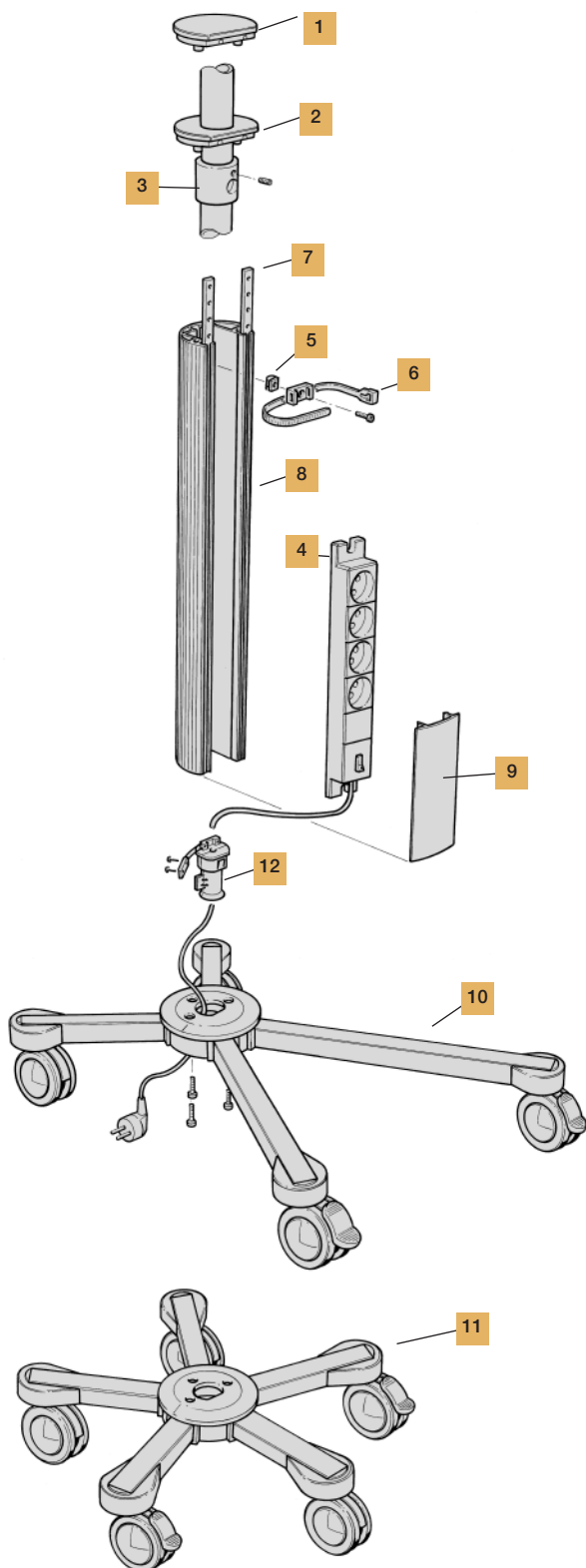

- 1** Cap made of plastic (ABS)
- 2** Cap made of plastic (ABS) with hole, used with accessories (e.g. swivel and tilt shelf, infusion stand, lamp, etc.)
- 3** Mounting for a bar (\varnothing 25 mm), e.g. from an infusion stand
- 4** Socket strip, variable mounting in the rear T-slot of the support column
- 5** Spring nut M5 or M6
- 6** Cable tie
- 7** Tapped strip (made of steel), for mounting all system components on the support column (tapped hole M6 in increments of 32 mm)
- 8** Support column (made of extruded aluminium) powder-coated
- 9** Cover strip (made of plastic), for closing the installation space in the support column between the system elements
- 10** Hub with 4 stabilizers (asymmetrical), zinc-plated steel tubing and powder-coated
- 11** Hub with 5 stabilizers (symmetrical), zinc-plated steel tubing and powder-coated
- 12** Strain relief (made of plastic)

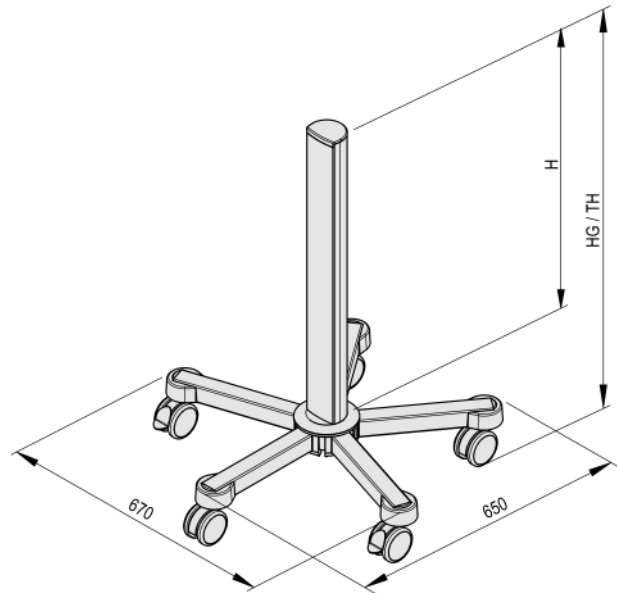
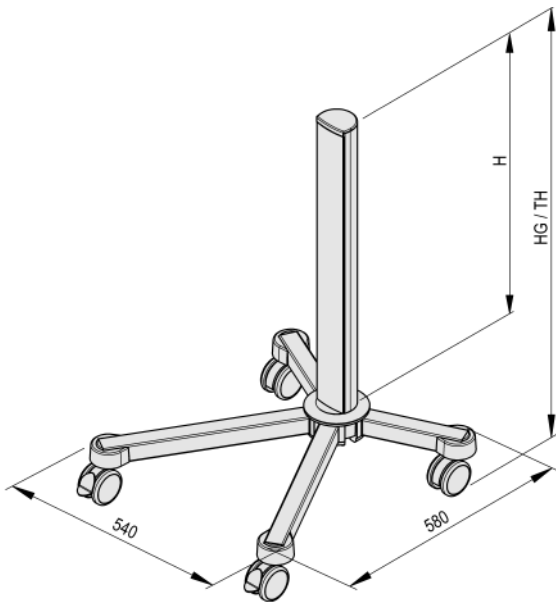

Installation height H	Length of the extrusion H	TH for Castors Ø 75 mm	TH for Castors Ø 100 mm
21 U ¹⁾	680 mm	820 mm	857 mm
30 U ¹⁾	968 mm		1145 mm
35 U ¹⁾	1128 mm		1305 mm

Load capacity

- Basic frame total payload 50 kg / 110.0 lbs
- Shelf 10 kg / 22.0 lbs
- Drawer 3 kg / 6.6 lbs

Storage area

- Shelf W x D 400 mm x 360 mm
Other dimensions available on request.

Setup

- 1 base with 4 stabilizers (asymmetrical) or 5 stabilizers (symmetrical).
Positive and friction fit instead of welding
- 4 twin swivel castors Ø 75 mm or Ø 100 mm, two with wheel locks.
Both sizes are also supplied in conductive version
- 1 support column with two tapped strips (32 mm increments)
- Comprehensive range of system components and accessories for different applications
- Supplied partly assembled

¹⁾ 1 U = 32 mm

ORDER CONFIGURATIONS

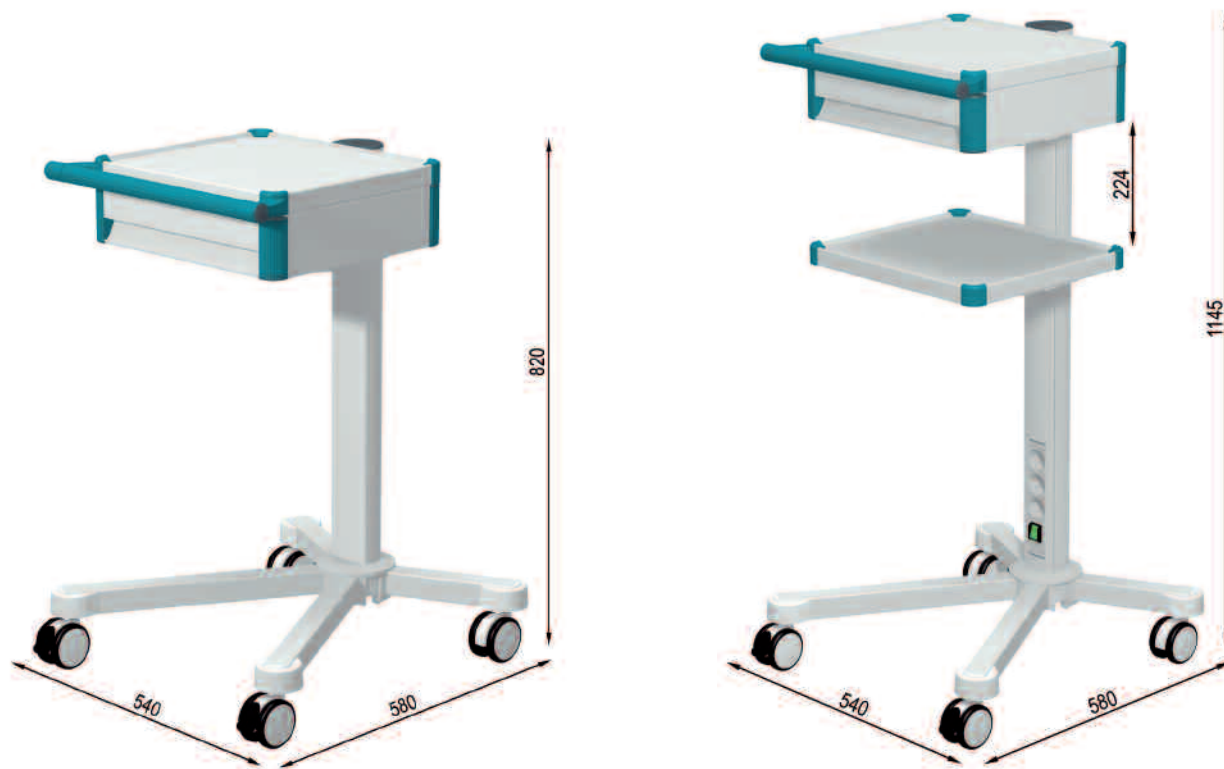

<p>uni-cart Type 1, 21 U ¹⁾</p> <p>Order number RS.4801.XXX ²⁾</p>	<p>uni-cart Type 2, 30 U ¹⁾</p> <p>Order number RS.4111.XXX ²⁾</p>
<p>Basic frame 21 U¹⁾, with 4 stabilizers, fitted with:</p> <ul style="list-style-type: none"> ■ 4 twin swivel castors Ø 75 mm, 2 with wheel locks ■ 1 block of drawers with handle, W 400 x D 360 mm ■ 1 cover strip and cap ■ 1 integrated cable strain relief 	<p>Basic frame 30 U¹⁾, with 4 stabilizers, fitted with</p> <ul style="list-style-type: none"> ■ 4 twin swivel castors Ø 100 mm, 2 with wheel locks ■ 1 block of drawers with handle, W 400 x D 360 mm ■ 1 shelf, W 400 x D 360 mm ■ 1 socket strip 3-way, with on and off switch ■ 1 cover strip and cap ■ 1 integrated cable strain relief
<p>Load capacity: 50 kg / 110 lbs</p> <p>Finish:</p> <ul style="list-style-type: none"> ■ RAL 7035 Light Grey powder-coated ■ Decorative trims and handles see optionally ²⁾ 	<p>Load capacity: 50 kg / 110 lbs</p> <p>Finish:</p> <ul style="list-style-type: none"> ■ RAL 7035 Light Grey powder-coated ■ Decorative trims and handles see optionally ²⁾

¹⁾ 1 U = 32 mm

²⁾ **Trim colour:** Make sure you replace .XXX with .901 = RAL 5021 Water Blue, .902 = RAL 5013 Cobalt Blue, .903 = RAL 7035 Light Grey



uni-cart mechanical height adjuster, 35 U ¹⁾

Order number RS.4143.XXX ²⁾

Basic frame 35 U¹⁾, with 4 stabilizers, fitted with:

- 4 twin swivel castors Ø 100 mm, 2 with wheel locks
- 1 height adjuster with monitor handle, swivel and tilt unit and
- 1 keyboard holder with mousepad
- 1 cover strip and cap
- 1 integrated cable strain relief
- For mounting flat screen and keyboard. (height adjustable as a unit)
- Deployable as sit/stand workstation
- Side handles facilitate swivel and tilt of the monitor
- Optimum position of the keyboard to the screen
- For mounting screens with VESA 75 or VESA 100 adaptors
- Rated payload 7 - 10 kg / 15.4 - 22 lbs. Additional payload on request

Load capacity: 50 kg / 110 lbs

Finish:

- Support column aluminium natural anodized
- Monitor handle see optionally ²⁾:
- All other elements RAL 7035 Light Grey powder-coated

¹⁾ 1 U = 32 mm

²⁾ **Trim colour:** Make sure you replace .XXX with .901 = RAL 5021 Water Blue, .902 = RAL 5013 Cobalt Blue, .903 = RAL 7035 Light Grey

ORDER CONFIGURATIONS



uni-cart power height adjuster, 35 U ¹⁾

Order number RS.4145.XXX ²⁾ (with 230 V Input voltage)

Order number RS.4146.XXX ²⁾ (with 110 V Input voltage)

Basic frame with 4 stabilizers,
fitted with:

- 4 twin swivel castors Ø 100 mm,
2 with wheel locks
- 1 power height adjuster with power pack
(input: 110 V / 230 V and 50 / 60 Hz)
- 1 remote control for the height adjuster
- 1 monitor mounting VESA 75 / 100
to 14 kg / 30.8 lbs monitor weight
- 1 keyboard holder with pullout mousepad
right / left
- 1 EURO socket strip, 3-way,
with on and off switch
- 1 handle rear
- 1 computer holder
- 1 connecting cable earthed, length 5 m
- 1 integrated cable strain relief
- 1 cable duct
- 1 cable winder

Load capacity: 50 kg / 110 lbs

Finish:

- RAL 7035 Light Grey powder-coated
- **Handle** see optionally ²⁾

¹⁾ 1 U = 32 mm

²⁾ **Trim colour:** Make sure you replace .XXX with .901 = RAL 5021 Water Blue, .902 = RAL 5013 Cobalt Blue, .903 = RAL 7035 Light Grey

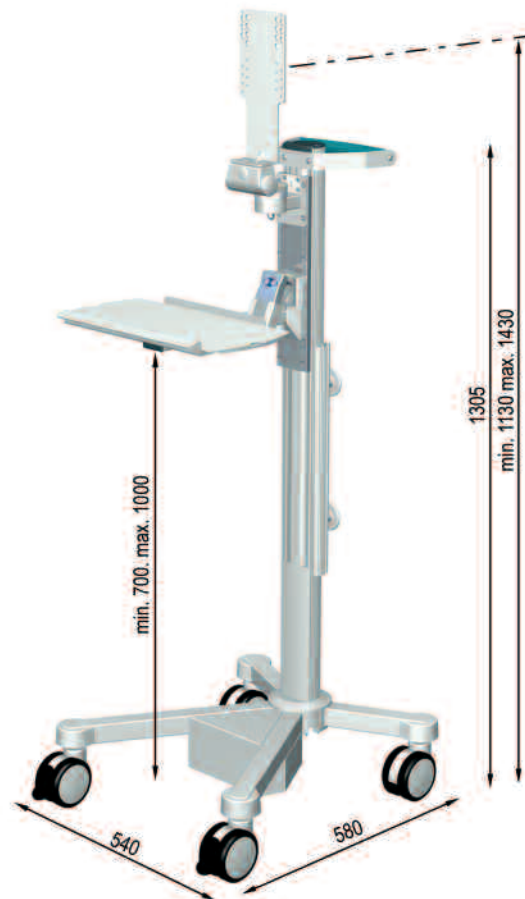

uni-cart power height adjuster, 35 U ¹⁾

Order number RS.4147.XXX ²⁾ (with 230 V Input voltage)

Order number RS.4148.XXX ²⁾ (with 110 V Input voltage)

Basic frame with 4 stabilizers,
fitted with:

- 4 twin swivel castors Ø 100 mm,
2 with wheel locks
- 1 power height adjuster with power pack
(input: 110 V / 230 V and 50 / 60 Hz)
- 1 remote control for the height adjuster
- 1 monitor mounting VESA 75 / 100
to 14 kg / 30.8 lbs monitor weight
- 1 keyboard holder with pullout mousepad
right / left
- 1 handle rear
- 1 connecting cable earthed, length 5 m
- 1 integrated cable strain relief
- 1 cable duct
- 1 cable winder

Load capacity: 50 kg / 110 lbs

Finish:

- RAL 7035 Light Grey powder-coated
- **Handle** see optionally ²⁾

¹⁾ 1 U = 32 mm

²⁾ **Trim colour:** Make sure you replace .XXX with .901 = RAL 5021 Water Blue, .902 = RAL 5013 Cobalt Blue, .903 = RAL 7035 Light Grey

ORDER CONFIGURATIONS



uni-cart Rollstand, 32 U ¹⁾

Order number RS.4903.800

for Philips IntelliVue MP20/30, MP40/50 or MP60/70

Basic frame with 5 stabilizers,
fitted with:

- 5 twin swivel castors Ø 100 mm,
2 with wheel locks
- 1 swivel and tilt Quickmount unit for
Philips IntelliVue MP20/30, MP40/50 and MP60/70
- 1 handle
- 1 vertical holder for external rack
- 1 basket
- 1 cover strip and cap
- 1 integrated cable strain relief

Load capacity: 50 kg / 110 lbs

Finish:

- Arctic White
- **Decorative trims:** Medium Aqua Accent

¹⁾ 1 U = 32 mm

OVERVIEW

SYSTEM COMPONENTS AND ACCESSORIES

Basic frames	4 stabilizers	21 U: RS.4008.991 30 U: RS.4011.991 35 U: RS.4027.991
	5 stabilizers	21 U: RS.5008.991 30 U: RS.5011.991 35 U: RS.5024.991
Castor conversion kit	Ø 100 mm, instead of standard Ø 75 mm	4-part Set: ZV.9920.999 5-part Set: ZV.9926.999
	Ø 100 mm, conductive, instead of standard Ø 75 mm	4-part Set: ZV.9921.999 5-part Set: ZV.9927.999
	Ø 100 mm, conductive, instead of standard Ø 100 mm	4-part Set: ZV.9922.999 5-part Set: ZV.9929.999
Shelf	without handle	RS.4360.XXX ¹⁾
	with handle	RS.4361.XXX ¹⁾
	with mousepad	RS.4370.XXX ¹⁾
	with handle and mousepad	RS.4372.XXX ¹⁾
Rack base	installation depth 400 mm, width 450 mm	RS.0143.991
Monitor holder	for monitors with VESA 75 / 100 adaptors up to 17.6 lbs	RS.0296.991
	with universal adapter to accommodate specific adapter panels	RS.0101.800
Block of drawers	without handle	RS.4363.XXX ¹⁾
	with handle	RS.4364.XXX ¹⁾
	with mousepad	RS.4369.XXX ¹⁾
	with handle and mousepad	RS.4368.XXX ¹⁾
Basket	storage basket tapered, 305 x 205 mm, assembly in the front T-slots	ZV.9967.800
	storage basket tapered, 305 x 205 mm, assembly at the rear	ZV.9989.991
	stainless steel basket, 403 x 200 mm, assembly in the front T-slots	ZV.9893.999
	storage basket tapered, 305 x 93 mm, assembly in the front T-slots	ZV.9892.991
Endoscope holder	for assembly on 2 shelves	<i>single</i> GW.0394.991
		<i>double</i> GW.0473.991
	for assembly in the support column	RS.0115.800
Drain glass		ZV.9963.999
Connector holder		ZV.9833.999
Hose holder		GW.9882.999
Camera holder	assembly at the side on the shelf	GW.9990.999
	with clamp	GW.9983.991
	with mounting	GW.9808.991
Gel bottle holder		GW.0800.991
Gas bottle holders	for gas bottles with max. 2 l content	GW.0466.991
	for gas bottles with max. 2 l content	RS.0110.991
	for gas bottles with Ø 145 mm, 3 l / 5 l / 10 l content	RS.0111.991
Infusion stand	4-arm with one hand - adjustment	ZV.9881.800
Standard runner	for mounting at the front on the column	Length 390 mm RS.0076.991
		Length 162 mm RS.0132.991

¹⁾ **Trim colour:** Make sure you replace **.XXX** with **.901** = RAL 5021 Water Blue, **.902** = RAL 5013 Cobalt Blue, **.903** = RAL 7035 Light Grey

Anchor		ZV.9820.799
Holder for suction system	Strässle/Ergoline	RS.0318.991
Foot switch cradle	on the front of the support column mounting depth 47 mm	ZV.9991.991
Holder for transducer		RS.0131.991
Box holder	"Dracula", for single-use glove boxes	ZV.9832.999
Pivot arm	single, with VESA 75 adaptation for flat screen	TS.6314.991
	double, with VESA 75 adaptation for flat screen	TS.6315.991
Variable height arm	length 400 mm, with VESA 75 adaptation for flat screen	ZV.9538.999
Jointed arm	with hose clamps, for cable management	ZV.9955.799
Handles	radiused, assembly in the front T-slots of the support column	RS.0160.XXX ¹⁾
Socket strips	3-way socket strip	ZV.9844.999
	3-way, Swiss standard	ZV.9848.999
	3-way, British standard	ZV.9758.999
Plug removal barrier	for 3-way earthed	GW.0632.991
Cable winder		RS.0267.991
Isolating transformer	660 VA	ZV.9412.999

¹⁾ **Trim colour:** Make sure you replace .XXX with .901 = RAL 5021 Water Blue, .902 = RAL 5013 Cobalt Blue, .903 = RAL 7035 Light Grey

You will find a comprehensive description and ordering information on all components suitable for **uni-cart** in the **system components and accessories** section.

System components and accessories	from page	94
Order number index	from page	180